

## OMS 121 UP-CH (Swiss Version)

POF network socket 2 x RJ45 flush-mounted 100 Mbps - Fast Ethernet

### Product Description



POF flush-mounted Switch with integrated media converter to provide network access at the electrical installations.

Power supply over L/N wiring clamp on the side of the device.

The POF network socket is suitable for home- and office networks. With the POF network socket 2 common RJ45 interfaces can be provided in a room beside the electrical installation.

Standard cover plates for System Feller are included in the scope of delivery (DIN UAE 8/8).

### Application Example:

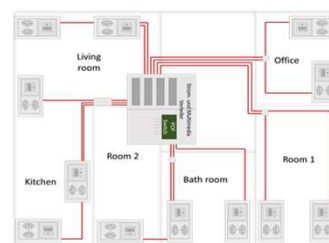

Purchase Unit (PU)	Content	Unit	width (PU in mm)	depth (PU in mm)	height (PU in mm)	weight (PU in kg)
OMS 121 UP-CH	1	Pcs.	85	85	60	0.10

### Characteristics

product category	switch
ports / number of ports	2 x RJ45, 1 x POF
bandwidth	Fast Ethernet
operating temperature	0 °C to +45 °C (32 °F to 113 °F)
degree of protection according to DIN EN 60529	IP20
class of protection according to DIN EN 61140	II
installation	flush-mounted
device dimensions (WxDxH) in mm	55.0 x 50.0 x 53.0
weight in gramm	73 g

### Power and Consumption

power connector	internal power supply, L/N: wiring clamp for fixed wires 1.5 mm <sup>2</sup>
voltage rating	(100-240) V AC (50-60) Hz
power consumption	typ. 1 W

### Network ports

number of network ports	2 x RJ45
information rate of network ports	100 Mbps
transmission distance of network ports	100 m
preferred cable for network ports	CAT 5e, 6
bandwidth network ports	100 MHz

### Optical network ports

number of optical ports	1 x POF connector less / Optolock for 2.2 mm POF cable
information rate of optical ports	100 Mbps
transmission distance of optical ports	80 m
preferred cable for optical ports	POF 2.2 mm class A4a.2 according IEC60793-2
wave length of optical ports	650 nm visible red light, harmless to the eye

### Standards

ethernet standards	IEEE 802.3, IEEE 802.3u
CE / RoHS	CE marked, RoHS compliant
FCC	N/A

1.0

homefibre digital network gmbh | Fratresstrasse 20 | 9800 Spittal a. d. Drau | Austria

Telephone +43 4762 35391 | Fax +43 4762 42780 | welcome@homefibre.at | www.homefibre.at